

Providence, Rhode Island



RHODE ISLAND
CONVENTION &
ENTERTAINMENT
COMPLEX



Rhode Island Convention Center



Dunkin' Donuts Center



Veterans Memorial Auditorium

Welcome to Providence, Rhode Island

A unique blend of big city amenities and small town charm, Providence is home to critically acclaimed restaurants, a vibrant arts community, and world-class universities. This distinctive mix has proved popular with visitors, resulting in Providence being named one of "America's Favorite Cities" by *Travel + Leisure* and one of the "Top Ten Up-and-Coming Travel Destinations in the World" by the *Wall Street Journal*, among other accolades.

Nearby Warwick, Rhode Island features miles of scenic coastline and offers additional hotel, dining, shopping and entertainment options. For those flying into Providence, Warwick's T.F. Green Airport is just a short, 10-minute drive from downtown. A new Interlink transportation system allows for scheduled rail service from the airport to Providence and Boston.

Located between New York City and Boston, Providence is easily accessible for event attendees, and about 25 percent of the United States' population lives within 500 miles of the city. The Amtrak train station is located within walking distance of the Complex, and offers rail service throughout the Northeast Corridor.



critically acclaimed restaurants

About the Rhode Island Convention & Entertainment Complex

The Rhode Island Convention & Entertainment Complex stands in the heart of the city, and includes the Rhode Island Convention Center (RICC), the Dunkin' Donuts Center (Dunk) and the Veterans Memorial Auditorium (VMA). The Complex is conveniently located within one mile of nearly 2,200 hotel rooms and

a broad spectrum of dining, shopping, arts and entertainment options.

When every detail must be perfect, you can count on the Rhode Island Convention Center's experienced team to execute flawless meetings, conventions, trade shows, conferences, training sessions, and social functions. The RICC contains 100,000 square feet of flexible meeting and convention space and is directly connected to the 564-room Westin Providence Hotel.

Connected to the RICC, the Dunkin' Donuts Center has a 30-year history of hosting sporting events, concerts, family shows and

more. Recent renovations to the Dunk have transformed the property into a state-of-the-art-facility for myriad sporting and special events, as well as large meetings. Additional meeting rooms and party suites, make the Dunk a unique location for smaller groups.

Known for its unique combination of size and intimacy, celebrated acoustics and grand proscenium stage, the VMA is an elegant performance venue and a memorable place to hold a corporate or community event. This historic property is listed on the National Register of Historic Places.



Rhode Island Convention Center

1st Floor

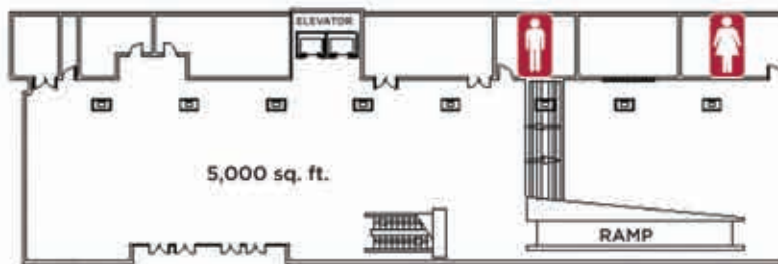

West Lobby (lower level)

Banquet	300ppl
Reception	500ppl
Classroom	230ppl
Theater	450ppl

3rd Floor



AREA	Gross Sq. Ft.	Dimensions	Max# 10 x 10 Booths	Theater	Classroom	Banquet
Hall A	27,608	238' x 116'	150	2,880	1,790	2,000
Hall B	28,560	238' x 120'	150	2,728	1,638	1,620
Hall C	28,560	238' x 120'	150	2,728	1,638	1,620
Hall D	15,272	VARIABLES	50	1,164	576	600
Halls A+B+C+D	100,000	VARIABLES	500	9,500	5,642	5,500

Exhibit Hall ceiling height 30'

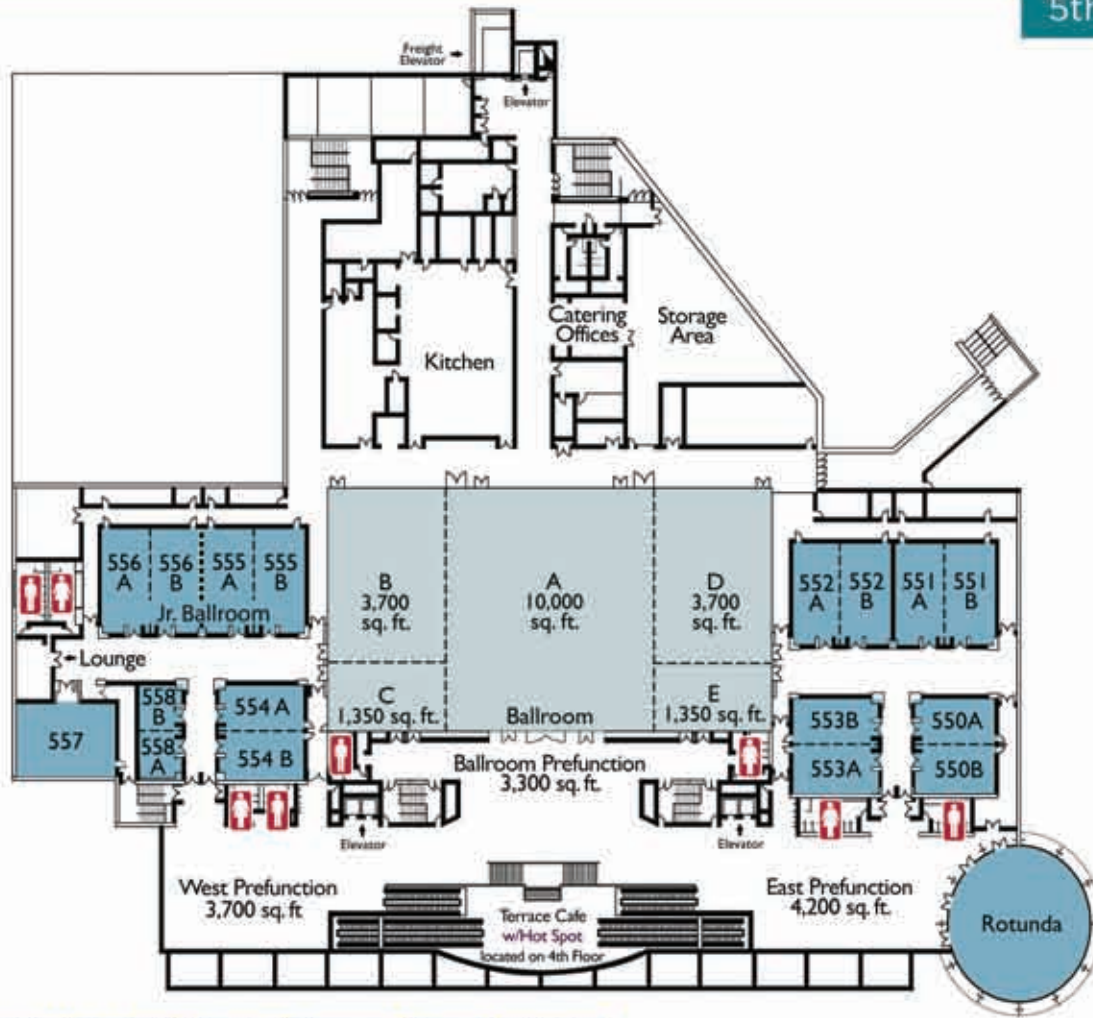

ROOM	Sq. Feet	Theatre	Classroom	Banquet	LXW
550A	589	55	24	40	31'x19'
550B	589	55	24	40	31'x19'
550 A+B	1,178	110	57	80	31'x38'
551A	968	96	54	60	44'x22'
551B	968	96	54	60	44'x22'
551 A+B	1,936	192	108	120	44'x44'
552A	1,012	99	54	60	44'x23'
552B	1,012	99	54	60	44'x23'
552 A+B	2,024	198	108	120	44'x46'
553A	722	80	36	50	38'x19'
553B	722	80	36	50	38'x19'
553 A+B	1,444	160	90	120	38'x38'
554A	722	80	36	50	38'x19'
554B	722	80	36	50	38'x19'
554 A+B	1,444	160	90	120	38'x38'
555A	1,012	105	54	60	44'x23'
555B	1,012	105	54	60	44'x23'
555 A+B	2,024	210	108	120	44'x46'
556A	990	105	54	60	44'x23'
556B	990	105	54	60	44'x23'
556 A+B	1,980	210	108	120	44'x46'
557	1,350	132	84	110	30'x45'
558A	304	24	18	20	38'x8'
558B	304	24	18	20	38'x8'
558 A+B	608	60	36	40	38'x16'
ROTUNDA	2,552	212	108	160	

Meeting Rooms ceiling height 15'

- 100,000 sq. ft. Exhibition Hall
- 20,000 sq. ft. Grand Ballroom
- 23 meeting rooms and 30,000 sq. ft. pre-function space
- Connected to the Westin Hotel and Providence Place mall
- Two parking garages accommodating 2,400 cars
- 10 loading docks with ramp access to show level

ROOM	Sq. Feet	Theatre	Classroom	Banquet	LXW
Ball A	10,000	1,175	756	680	100'x100'
Ball B	3,700	414	234	210	74'x50'
Ball C	1,350	120	54	80	27'x50'
Ball D	3,700	414	234	210	74'x50'
Ball E	1,350	120	54	80	27'x50'
Ball B+C	5,050	550	324	280	100'x50'
Ball D+E	5,050	550	324	280	100'x50'
A+B+C+D+E	20,000	2,300	1,400	1,400	100'x200'
Jr. Ballroom 555/556	4,004	420	216	240	91'x44'

Ballroom ceiling height 23'

Dunkin' Donuts Center

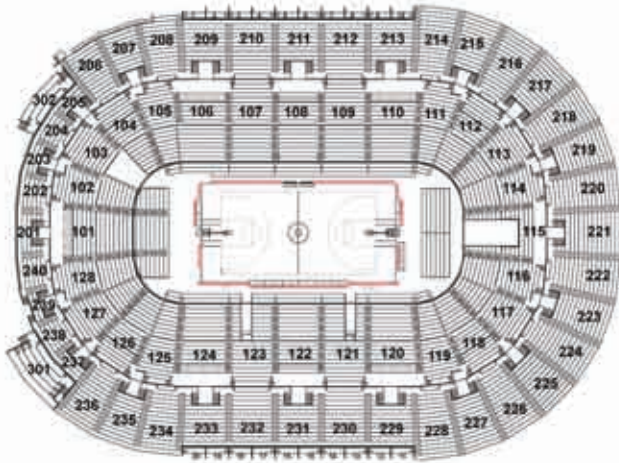

- 13,000 seat indoor arena
- 31,000 sq. ft. arena floor
- 25,000 sq. ft. concourse
- Additional meeting and hospitality rooms
- Party suites
- Connected to the RI Convention Center

Veterans Memorial Auditorium

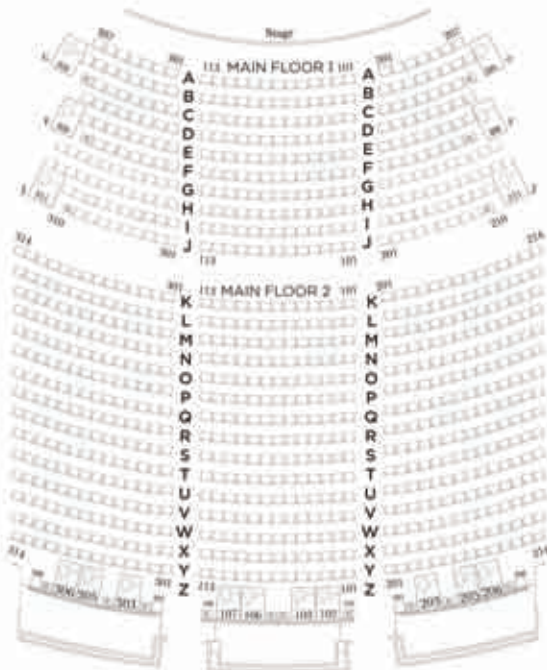

- 1,900 seats
- National Register of Historic Places
- Hospitality and meeting space
- Stage size = 45' deep x 85' wide = 3,825 sq. ft.

Providence Hotels

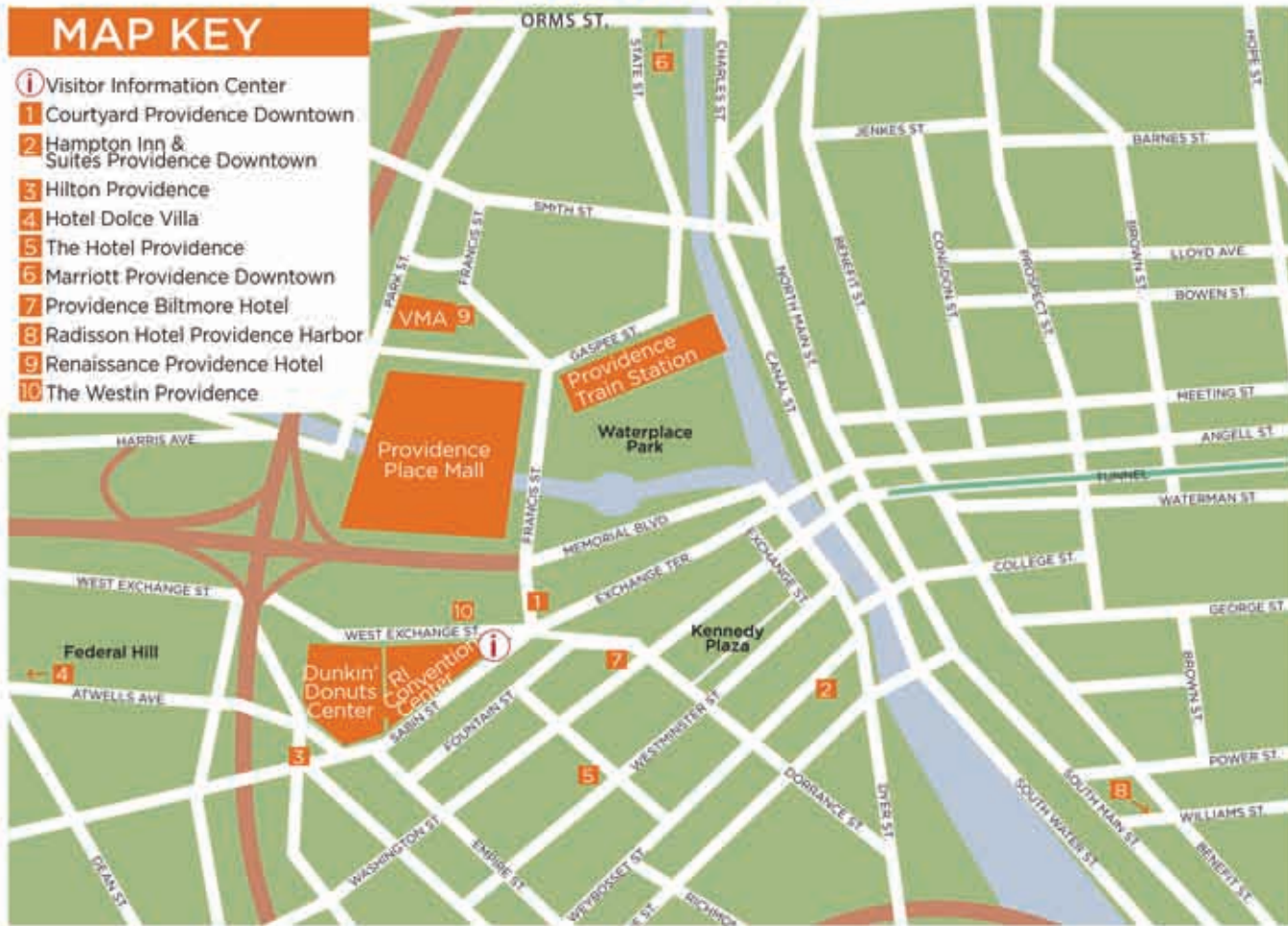

The Rhode Island Convention & Entertainment Complex

Rhode Island Convention Center

One Sabin Street
 Providence, RI 02903
 Ph: 401-458-6000
 Fax: 401-458-6500
www.RIConvention.com
jmcginn@smgricc.com



Veterans Memorial Auditorium

One Avenue of the Arts
 Providence, RI 02903
 Ph: 401-222-1467
 Fax: 401-222-1466
www.vmari.com
info@vmari.com



Dunkin' Donuts Center

One LaSalle Square
 Providence, RI 02903
 Ph: 401-331-0700 x7112
 Fax: 401-621-5987
www.DunkinDonutsCenter.com
dpolselli@dunkindonutscenter.com



Convention & Visitors Bureau

144 Westminster Street
 Providence, RI 02903
 Ph: 401-456-0200
 Fax: 401-273-7046
www.GoProvidence.com
meetings@pwcvb.com
PROVIDENCE • WARWICK
 Convention & Visitors Bureau